

Rohs Compliance

REV	DESCRIPTION	DATE	BY
A	FIRST ISSUE		

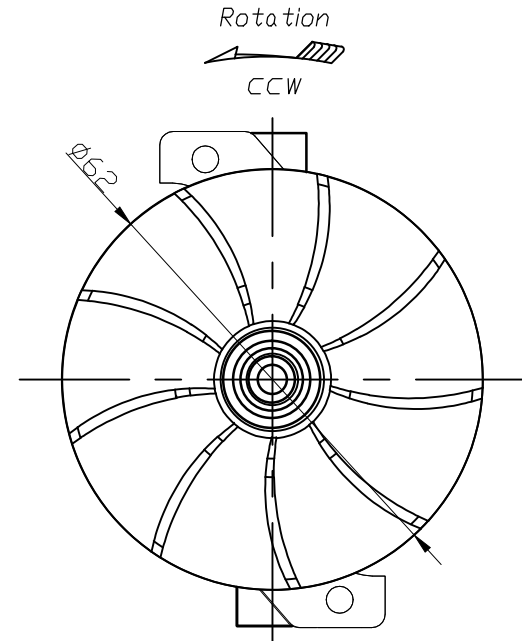
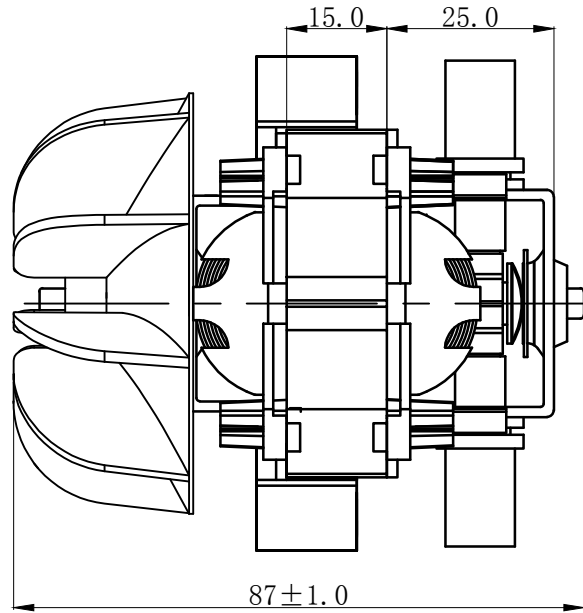
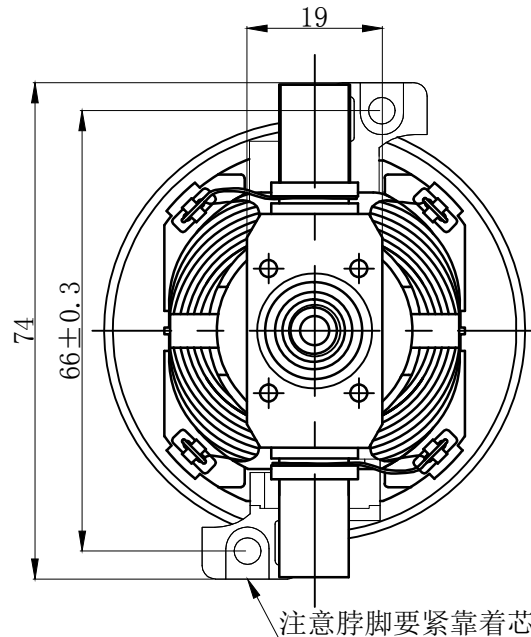

电机规格说明

1. 电机类型: 串激电机

额定电压: 230V/50Hz

绝缘等级: Class B

2. 电机性能:

a 空载电流: 0.3A ± 15%

f 负载电流: 0.75A ± 10%

b 空载功率: 65 ± 15% W

g 负载功率: 165 ± 10% W

c 空载转速: 33500 ± 15% RPM

h 负载转速: 15000 ± 10% RPM

d 火花等级: 1.5级MAX

i 负载类型: $\phi 62 \times 9 \text{P}$ 吹风机风叶

3. 电机旋向: 马达转向为CCW从轴伸端视

4. 安全测试: 耐压1800V/0.5mA · 1sec

5. 游隙控制在0.5~1.0mm以内。

6. 电机振动小于8mm/秒。

7. 螺丝反扭力大于或等于5KG.

Notes:

1. Voltage with Frequency (电压和频率): 230V/50Hz

2. Rotation (转向): CCW

3. No-load Performance (空载性能)

No-load Speed (空载转速): 33500 ± 15% RPM

No-load Current (空载电流): 0.3A ± 15%

No-load Power (空载功率): 65W ± 15%

4. On load Performance (负载性能) (With Fan)

On load Speed (负载转速): 15000 ± 10% RPM

On load Current (负载电流): 0.75A ± 10%

On load Power (负载功率): 165A ± 10%

5. Insulation Grade (绝缘等级): Class B

6. Withstand Voltage (耐压):

1800V/0.5mA/1sec

7. Life (寿命): >800H

8. Noise (噪音): 75dB-M

电机电路示意图:

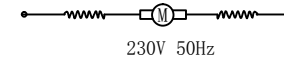

Label content:

U-5415
230V/50Hz
Next Power

DWN. BY: GYZ	CHK. BY: Edward	APP. BY:
Date (yyyymmdd): 2016-4-10	Date (yyyymmdd): 2016-4-10	Date (yyyymmdd):
MATERIAL:		
FINISH:		
General Tolerance ISO 2768-1 Class m (Unless specified)		TITLE
ALL DIMENSIONS ARE IN MILLIMETRES		OD-5415M23-1 230V/50Hz
		DWG NO.
SHENZHEN ODIN IMPORT AND EXPORT CO., LTD		OD-5415M23-1
		SHEET 1 OF 1