

SPECIFICATION

RATED VOLTAGE	电压	220-240V ~	NO-LOAD STARTING VOLTAGE空载启动	154V
FREQUENCY	频率	50Hz	INSULATION RESISTANCE 绝缘电阻	≥100MΩ
CURRENT	电流	0.03A	NOISE 噪音	≤45dB(A)
INPUT POWER	功率	4W	TEMPERATURE RISE 温升	≤ 60 K
OUTPUT SPEED	转速	1.8RPM	INSULATION CLASS 绝缘等级	H
OUTPUT TORQUE力矩	AT25°C	≥ 180 N cm	ROTATION DIRECTION 转向	FREE

设计 校对 审核 工艺				标准化 规定 批注 日期				图样标记 重量 比例 1.25:1			
共 1 页				第 1 页				OUTLINE 26M02			

TY49-A 220-240V~ 50/60Hz  
4W CI II T125°C Date 0719

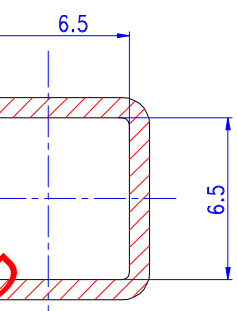

4:1

### Inspection report of TY49-A(M2602) motor

Item No.	Voltage	Frequency	Power	Current	Speed	Hi-pot	Temperature rise	condition of enamellea wire	Insulation Resistance	Low voltage Start	Maxi • mum Torque (at20°C)
	V	Hz	W	A	RPM	1500V/m	60K	non-tighten	100M Ω	V	mN • m
1	230	50	4.8	0.023	1.8	OK	OK	OK	OK	154	2030
2	230	50	4.8	0.023	1.8	OK	OK	OK	OK	154	2050
3	230	50	4.7	0.024	1.8	OK	OK	OK	OK	154	2040
4	230	50	4.9	0.023	1.8	OK	OK	OK	OK	154	2060
5	230	50	4.8	0.024	1.8	OK	OK	OK	OK	154	2030
6	230	50	4.8	0.023	1.8	OK	OK	OK	OK	154	2030
7	230	50	4.7	0.023	1.8	OK	OK	OK	OK	154	2060
8	230	50	4.8	0.024	1.8	OK	OK	OK	OK	154	2070
9											
10											

Date : 2019-08-15

Inspector: WANGWEI

Verified By: CHEN SHUNLI

TEAMWORK GLOBAL GROUP LIMITED  
www.tw-motor.com